

WINDOW SCHEDULE

LOCATION	QTY.	SIZE	OPERATION	NOTES
ENTRY	2	3066	SH - S.G.	GRID PER ELEVATION
ENTRY	1	6010	PC - ENTRY	GRID PER ELEVATION
DEN	2	3066	SH	GRID PER ELEVATION
DEN	2	2666	SH	GRID PER ELEVATION
POWDER	1	2666	SH	GRID PER ELEVATION
DINING	3	3070	SH - S.G.	GRID PER ELEVATION
FAMILY	1	18090	XXXX-S.G.D. - SG	GRID PER ELEVATION
KITCHEN	3	3053	SH	GRID PER ELEVATION
TECH	1	3053	SH	GRID PER ELEVATION
G. SUITE	2	3070	PC	GRID PER ELEVATION
G. SUITE	1	8090	OX-S.G.D. - S.G.	GRID PER ELEVATION
G. SUITE	2	3016	PC	GRID PER ELEVATION
G. BATH	2	3070	SH - S.G.	GRID PER ELEVATION

NOTE: WINDOW VENDOR TO VERIFY SCHEDULE WITH PLAN SET

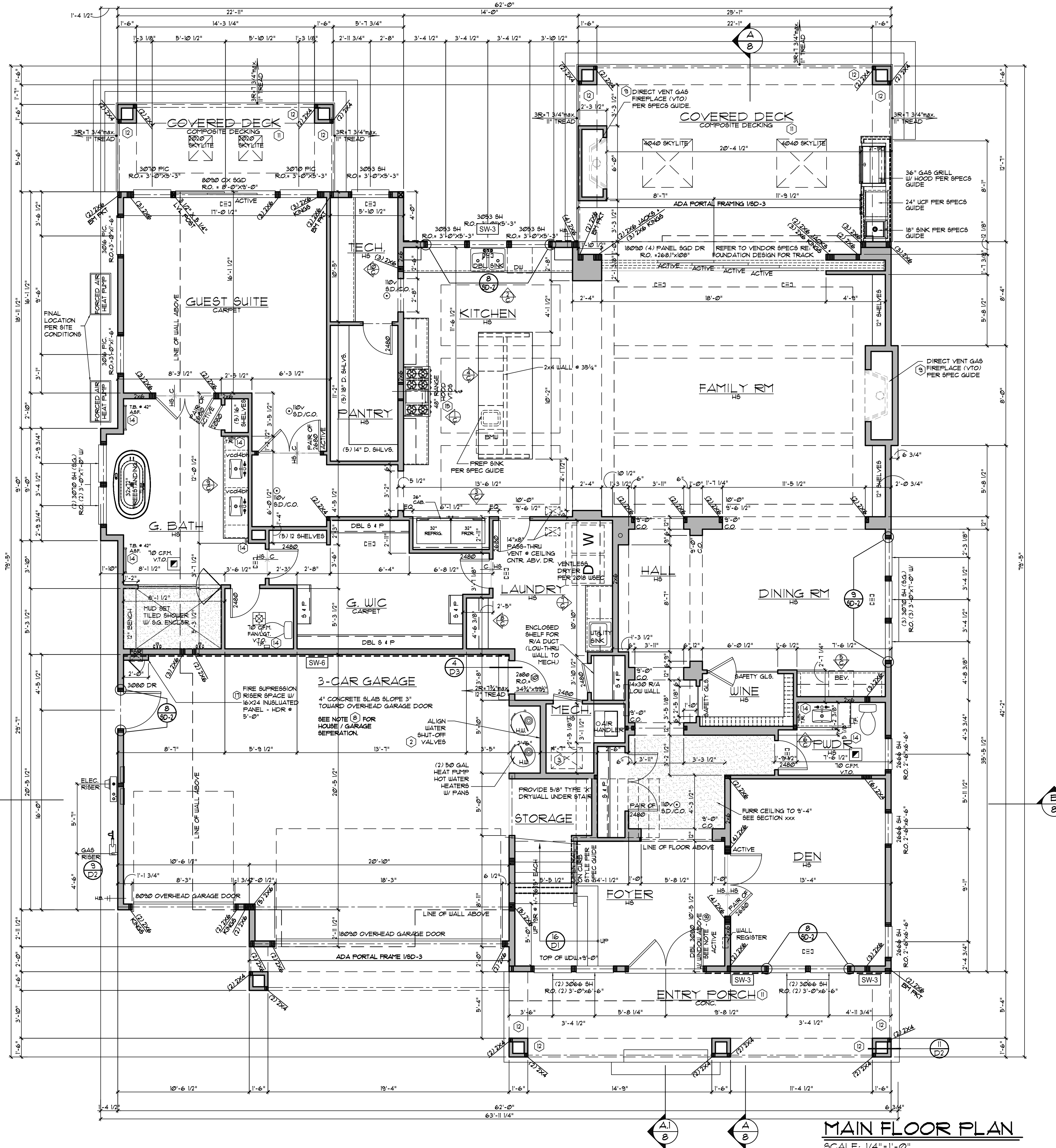

MAIN FLOOR PLAN

SCALE: 1/4" = 1'-0"

MAIN FLOOR PLAN NOTES

- SEE UPPER FLOOR FRAMING FOR ALL HEADER & BEAM CALL-OUTS
- EXTERIOR WALLS SHALL BE 2x6 HPF @ 16" o.c. AND INTERIOR WALLS 2x4 HPF @ 16" o.c.
- MAIN FLOOR PLATE HEIGHT SHALL BE 10'-0", TYP. UNO.
- TOP OF WINDOWS @ 9'-0" ABOVE FLOOR TYP. UNO.
- INDICATES BEARING STUDS:
- ALL BEAMS AND GIRDERS TO HAVE (2) 2x STUDS (UNO.)
- ALL HEADERS TO HAVE (1) 2x TRIMMER STUD (UNO.) & (1) KING STUD (1x (2) 2x + (3) 2x TRIMMER STUDS + (1) 2x KING STUD)
- INDICATES SHEAR WALL, DASHED LINE INDICATES EXTENT AND WALL SIDE OF SHEAR WALL SHEATHING FRAME PER SHEARWALL SCHEDULE. ALL EXTERIOR WALLS SHALL BE SHEAR WALL TYPE SW-6, UNO.
- INDICATES BOLTED HOLDOWNS, SEE STRUCTURAL DETAILS PROVIDED. REFER TO FOUNDATION PLAN FOR HOLDOWNS.
- INDICATES STRAP HOLDOWNS, SEE MAIN FLOOR FOR CALL-OUTS AND STRUCTURAL FOR INSTALLATION.
- ALL WINDOWS SHALL COMPLY W/ W.S.E.C. FRAMERS TO VERIFY ROUGH OPENINGS.
- PREFABRICATED FIREPLACES, CHIMNEYS AND RELATED COMPONENTS TO BEAR UL. SEAL OF APPROVAL AND TO BE INSTALLED PER MANUFACTURER'S SPECIFICATIONS.
- VENT ALL FANS AND DRYER EXHAUST TO OUTSIDE. PROVIDE 2x BLOCKING EACH SIDE OF FAN. HOLD BLOCKING 1/4" UP FROM GUB.
- TOILET PAPER DISPENSERS TO BE MOUNTED @ 21" AFF. (TYP.)
- ALL TOILET BARS MOUNTED @ 42" AFF. UNO.
- ALL ANGLED WALLS TO BE 45 DEG. UNO.
- DENOTES SUPPLY AIR GRILLE AT CEILING
- PROVIDE TEMPORARY BRACING AS REQUIRED UNTIL ALL CONNECTIONS AND STIFFENERS HAVE BEEN INSTALLED
- WRITTEN DIMENSIONS TAKE PRECEDENCE OVER SCALED DIM'S. VERIFY ALL DIMENSIONS AND CONDITIONS IN THE FIELD.
- SEE SHEET ECI FOR TYPICAL CONSTRUCTION REQUIREMENTS.
- CO = CARBON MONOXIDE ALARM & SMOKE DETECTOR
- 10V SMOKE DETECTOR W/ BATTERY BACKUP AND INTERCONNECTED ALARMS R314 I.R.C.
- FIREBLOCK IN ACCORDANCE W/ R302.11 I.R.C.
- LIMIT SHOWER FLOW TO 2.5 G.P.M.
- SHOWER WALLS SHALL BE WATERPROOF TO A MIN. 12" AFF.
- ALL BATHROOM GLAZING INCLUDING WINDOWS WITHIN 60" OF A STANDING OR A WALKING SURFACE SHALL HAVE SAFETY GLAZING.
- WATER HEATER SHALL BE PER 31 N.A.E.C.A. & SHALL HAVE 80 GALLON MINIMUM FIRST HOUR RATING, PRESSURE RELIEF VALVE TO EXTERIOR, RATED EXPANSION TANK (AS REQUIRED BY JURISDICTION), DRAIN PAN WITH DRAIN LINE TO AN APPROVED LOCATION (PER UPC 508.4). MAINTAIN 24" CLEARANCE IN FRONT OF THE WATER HEATER PER CODE. SECURE HUT WITH (2) 5/8" DIA. STRAPS.

- ALL IGNITION ELEMENTS FOR FURNACE AND WATER HEATER TO BE MIN. 18" ABOVE SLAB.
- HOSE BIBB AND WATER SHUT-OFF LOCATED AT REAR GARAGE WALL, TO BE INSTALLED IN CLOSE PROXIMITY TO EACH OTHER, AND BE ADJACENT NEAR THE WATER HEATER.
- 18"x24" CRAWL SPACE ACCESS W/ WEATHER STRIPPING PER USEC R402.2.4
- NOT USED
- NOT USED
- PROVIDE 2x8 BLOCK AT 54" AFF. FOR THERMOSTAT.
- FUR DOWN "WALL FOCKET" BEHIND REFRIGERATOR TO 80" ABOVE SUB-FLOOR. CABINET HFG TO PROVIDE BLOCKING/ SHIM FOR BOTTOM OF THE CABINET ABOVE REFRIGERATOR. RECEIVE 3/8" CLEAR FINISH WIDTH.
- 1/2" GYPSUM WALL BOARD ON ALL WALLS, POSTS AND BEAM 5/8" TYPE "X" GYPSUM WALL BOARD ON CEILINGS AND BEAMS. 5/8" TYPE "X" GYPSUM SHALL BE INSTALLED PERPENDICULAR TO THE CEILING FRAMING AND SHALL BE FASTENED AT MAX. 6 INCHES O.C. FASTENERS PER TABLE R102.3.5.
- DIRECT VENT GAS METAL FIREPLACE, INSTALL PER MANIF. SPECIFICATIONS, PROVIDE 6" DIA. OUTSIDE COMBUSTION AIR (RO. 38"X33").
- 20-MINUTE FIRE-RATED DOOR EQUIPPED WITH A SELF CLOSING DEVICE. IRC R302.5.1
- CEILING MATERIAL PER SPEC GUIDE
- FIBER CEMENT PANELS AT SOFFITS.
- BI-FOLD, R.O. = 4 1/4" X 82", BI-PASS, R.O. = WIDTH X 83" ROLLER CATCH FOR RAINTER SPEC
- BLKG REQUIRED FOR TOWEL BARS, HOOKS @ MUD RM, F.P. MANTLE, AND HANDRAIL
- RANGE HOOD WITH DISCHARGE TO OUTDOORS WITH DUCT AND DAMPER REQUIREMENTS PER IMC M503.1. SYSTEM TO BE INDEPENDENT OF ALL OTHER EXHAUST SYSTEMS. SEE ECI SHEET FOR REQUIREMENTS FOR MAKE-UP AIR WHEN RANGE HOOD EXHAUST IS IN EXCESS OF 400CFM
- NOT USED
- FIRE SPRINKLER RISER TO BE PART OF CONDITIONED SPACE, NO INSULATION IN THE WALLS BETWEEN THE RISER AND THE HOUSE. A 20-MINUTE FIRE-RATED ACCESS PANEL EQUIPPED WITH A SELF CLOSING DEVICE IS REQUIRED PER IRC R302.5.1, R-21 INSULATION AT PANEL WALL.

CODEL ENTRY DOORS W/ TRANSOM WINDOW (3" FRAMING IN BETWEEN)

3'-0" WITHOUT SIDELITE	DOOR: R.O. = 38 1/2" x 99" WINDOW: R.O. = 31" x 12"	3'-0" WITH TWO SIDELITES	DOOR: R.O. = 65 1/2" x 99" WINDOW: R.O. = 63 1/2" x 12"
3'-0" WITH ONE SIDELITE	DOOR: R.O. = 52" x 99" WINDOW: R.O. = 50 1/2" x 12"	DOUBLE 3'-0" WITHOUT SIDELITE	DOOR: R.O. = 75" x 99" WINDOW: R.O. = 75" x 12"

8090 XO SGD (R.O. = 96"X109") AT RAINTER SPEC ONLY

AREA CALCULATION:

MAIN FLOOR:	2846 SQ. FT.
UPPER FLOOR:	3093 SQ. FT.
TOTAL:	5939 SQ. FT.
GARAGE:	769 SQ. FT.
ENTRY PORCH:	209 SQ. FT.
COVERED DECKS:	498 SQ. FT.
OVERALL BUILDING DIMENSIONS (DOES NOT INCLUDE EAVES)	
WIDTH:	63'-11 1/4"
DEPTH:	79'-5"

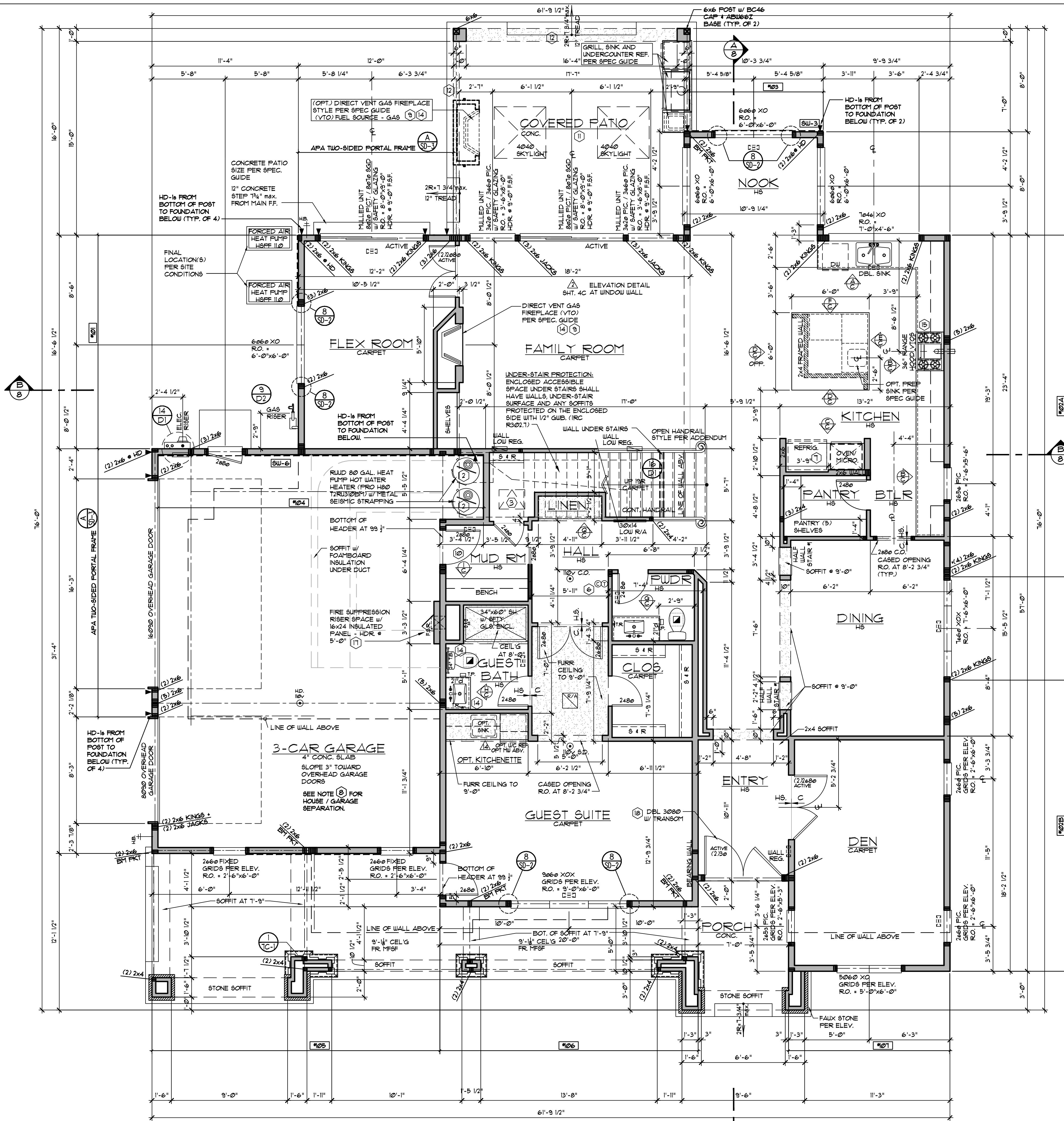

WINDOW SCHEDULE

LOCATION	QTY.	SIZE	OPERATION	NOTES
PORCH	1	61.510 (73.5" X 12")	PIC	WINDOW ABOVE ENTRY DOOR
DEN	1	2653	PIC	GRID PER ELEVATION
DEN	1	5060	XO	GRID PER ELEVATION
DEN	2	2660	PIC	GRID PER ELEVATION
DINING	2	7660	XOX	N/A
BUTLER	1	2656	PIC	N/A
NOOK	3	6060	XO	N/A
FAMILY RM	2	3620	PIC	MULLED UNIT, SAFETY GLASS @ LWR.
FAMILY RM	1	6020	PIC	MULLED UNIT, SAFETY GLASS @ LWR.
FLEX ROOM	1	6020	PIC	MULLED UNIT, SAFETY GLASS @ LWR.
FLEX ROOM	1	6060	XO	N/A
GARAGE	2	2660	PIC	FIXED; GRID PER ELEVATION
GUEST SUITE	1	9060	XOX	GRID PER ELEVATION

NOTE: WINDOW VENDOR TO VERIFY SCHEDULE WITH PLAN SET

MAIN FLOOR PLAN NOTES

- SEE UPPER FLOOR FRAMING FOR ALL HEADER & BEAM CALL-OUTS.
- EXTERIOR WALLS SHALL BE 2x6 HPF @ 16" o.c. AND INTERIOR WALLS 2x4 HPF @ 16" o.c.
- MAIN FLOOR PLATE HEIGHT SHALL BE 10'-0", TYP. UNO.
- TOP OF WINDOWS @ 9'-0" ABOVE FLOOR, TYP. UNO.
- INDICATES BEARING STUDS:
- ALL BEAMS AND GIRDERS TO HAVE (2) 2x STUDS (UNO.)
- ALL HEADERS TO HAVE (1) 2x TRIMMER STUD (UNO.) & (1) KING STUD (1x (3) 2x + (3) 2x TRIMMER STUDS + (1) 2x KING STUD.)
- INDICATES SHEAR WALL, DASHED LINE INDICATES EXTENT AND WALL SIDE OF SHEAR WALL SHEATHING FRAME PER SHEARWALL SCHEDULE. ALL EXTERIOR WALLS SHALL BE SHEAR WALL TYPE BU-6, UNO.
- INDICATES BOLTED HOLD-DOWNS, SEE STRUCTURAL DETAILS PROVIDED. REFER TO FOUNDATION PLAN FOR HOLD-DOWNS.
- INDICATES STRAP HOLD-DOWNS, SEE MAIN FLOOR FOR CALL-OUTS AND STRUCTURAL FOR INSTALLATION.
- ALL WINDOWS SHALL COMPLY W/ U.S.E.C. FRAMERS TO VERIFY ROUGH OPENINGS.
- PREFABRICATED FIREPLACES, CHIMNEYS AND RELATED COMPONENTS TO BEAR UL, SEAL OF APPROVAL AND TO BE INSTALLED PER MANUFACTURER'S SPECIFICATIONS.
- VENT ALL FANS AND DRYER EXHAUST TO OUTSIDE. PROVIDE 2x BLOCKING EACH SIDE OF FAN. HOLD BLOCKING 1/4" UP FROM GUB.
- TOILET PAPER DISPENSERS TO BE MOUNTED @ 21" AFF. (TYP.)
- ALL TOILET BARS MOUNTED @ 42" AFF. UNO.
- ALL ANGLED WALLS TO BE 45 DEG UNO.
- DENOTES SUPPLY AIR GRILLE AT CEILING.
- PROVIDE TEMPORARY BRACING AS REQUIRED UNTIL ALL CONNECTIONS AND STIFFENERS HAVE BEEN INSTALLED.
- WRITTEN DIMENSIONS TAKE PRECEDENCE OVER SCALED DIM'S. VERIFY ALL DIMENSIONS AND CONDITIONS IN THE FIELD.
- SEE SHEET ECI FOR TYPICAL CONSTRUCTION REQUIREMENTS.
- CO = CARBON MONOXIDE ALARM & SMOKE DETECTOR
- 120V SMOKE DETECTOR W/ BATTERY BACKUP AND INTERCONNECTED ALARMS R304 I.R.C.
- FIREBLOCK IN ACCORDANCE W/ R302.1 I.R.C.
- LIMIT SHOWER FLOW TO 2.5 G.P.M.
- SHOWER WALLS SHALL BE WATERPROOF TO A MIN. 12" AFF.
- ALL BATHROOM GLAZING INCLUDING WINDOWS WITHIN 60" OF A STANDING OR A WALKING SURFACE SHALL HAVE SAFETY GLAZING.
- WATER HEATER, PER 81 N.E.C.A. SHALL HAVE 60 GALLON MINIMUM FIRST HOUR RATING, PRESSURE RELIEF VALVE TO EXTERIOR, RATED EXPANSION TANK (AS REQUIRED BY JURISDICTION), DRAIN PAN WITH DRAIN LINE TO AN APPROVED LOCATION (PER UPC 508.4). MAINTAIN 24" CLEARANCE IN FRONT OF THE WATER HEATER PER CODE. SECURE HUT WITH (2) SEISMIC STRAPS.

- ALL IGNITION ELEMENTS FOR FURNACE AND WATER HEATER TO BE MIN. 18" ABOVE SLAB.
- HOSE BIBBS AND WATER SHUT-OFF LOCATED AT REAR GARAGE WALL, TO BE INSTALLED IN CLOSE PROXIMITY TO EACH OTHER AND BE ADJACENT NEAR THE WATER HEATER.
- 18"x24" CRAWL SPACE ACCESS W/ WEATHER STRIPPING PER USEC R402.2.4
- "NOT USED"
- "NOT USED"
- PROVIDE 2x8 BLOCK AT 34" AFF. FOR THERMOSTAT.
- RUR DOWN "WALL POCKET" BEHIND REFRIGERATOR TO 80" ABOVE SUBFLOOR CABINET TEGS TO PROVIDE BLOCKING/ SHIM FOR BOTTOM OF CABINET ABOVE REFRIGERATOR. RECESS 33" CLEAR FINISH WIDTH.
- 1/2" GYPSUM WALL BOARD ON ALL WALLS, POSTS AND BEAM 5/8" TYPE X GYPSUM WALL BOARD ON CEILING AND BEAMS. 5/8" TYPE X GYPSUM SHALL BE INSTALLED PERPENDICULAR TO THE CEILING FRAMING AND SHALL BE FASTENED AT MAX. 6 INCHES O.C. FASTENERS PER TABLE R102.3.5.
- DIRECT VENT GAS METAL FIREPLACE, INSTALL PER MANUF. SPECIFICATIONS. PROVIDE 6" dia. OUTSIDE COMBUSTION AIR (R.O. 38" W/314)
- 20-MINUTE FIRE-RATED DOOR EQUIPPED WITH A SELF CLOSING DEVICE. IRC R302.5.1
- CEILING MATERIAL PER SPEC GUIDE
- FIBER CEMENT PANELS AT SOFFITS.
- BI-FOLD: R.O. = 4 1/4" X 82", BI-PASS: R.O. = WIDTH X 83" ROLLER CATCH FOR RAINIER SPEC
- BLKG REQUIRED FOR TOILET BARS, HOOKS @ MUD RM, F.P. MANTLE, AND HANDRAIL
- RANGE HOOD WITH DISCHARGE TO OUTDOORS WITH DUCT AND DAMPER REQUIREMENTS PER IMC M1503.1. SYSTEM TO BE INDEPENDENT OF ALL OTHER EXHAUST SYSTEMS. SEE ECI SHEET FOR REQUIREMENTS FOR MAKE-UP AIR WHEN RANGE HOOD EXHAUST IS IN EXCESS OF 400CFM
- "NOT USED"
- FIRE SPRINKLER RISER TO BE PART OF CONDITIONED SPACE, NO INSULATION IN THE WALLS BETWEEN THE RISER AND THE HOUSE. A 20-MINUTE FIRE-RATED ACCESS PANEL EQUIPPED WITH A SELF CLOSING DEVICE IS REQUIRED PER IRC R302.5.1, R-21 INSULATION AT PANEL WALL.

CODEL ENTRY DOORS W/ TRANSOM WINDOW (3" FRAMING IN BETWEEN)			
3'-0" WITHOUT SIDELITE	DOOR: R.O. = 38 1/2" x 99"	3'-0" WITH TWO SIDELITES	DOOR: R.O. = 65 1/4" x 99"
	WINDOW R.O. = 31" x 12"		WINDOW R.O. = 63 3/4" x 12"
3'-0" WITH ONE SIDELITE	DOOR: R.O. = 52" x 99"	DOUBLE 3'-0" WITHOUT SIDELITE	DOOR: R.O. = 75" x 99"
	WINDOW R.O. = 50 1/4" x 12"		WINDOW R.O. = 73 1/4" x 12"

16 8090 XO SGD (R.O. = 96" W/108") AT RAINIER SPEC ONLY

MAIN FLOOR PLAN
SCALE: 1/4" = 1'-0"

AREA CALCULATION:

MAIN FLOOR:	2,335
UPPER FLOOR:	2,599
TOTAL:	4,934
GARAGE:	710
ENTRY PORCH:	445
COVERED PATIO:	311
OVERALL BUILDING DIMENSIONS (DOES NOT INCLUDE BAYES)	
WIDTH:	61'-10"
DEPTH:	76'-0"